

MODEL NUMBER:

- ❑ **9090.110.002 Centerset Lavatory Faucet**
Pop-up drain. Metal lever handle. Polished Chrome finish.
SKU #40065.

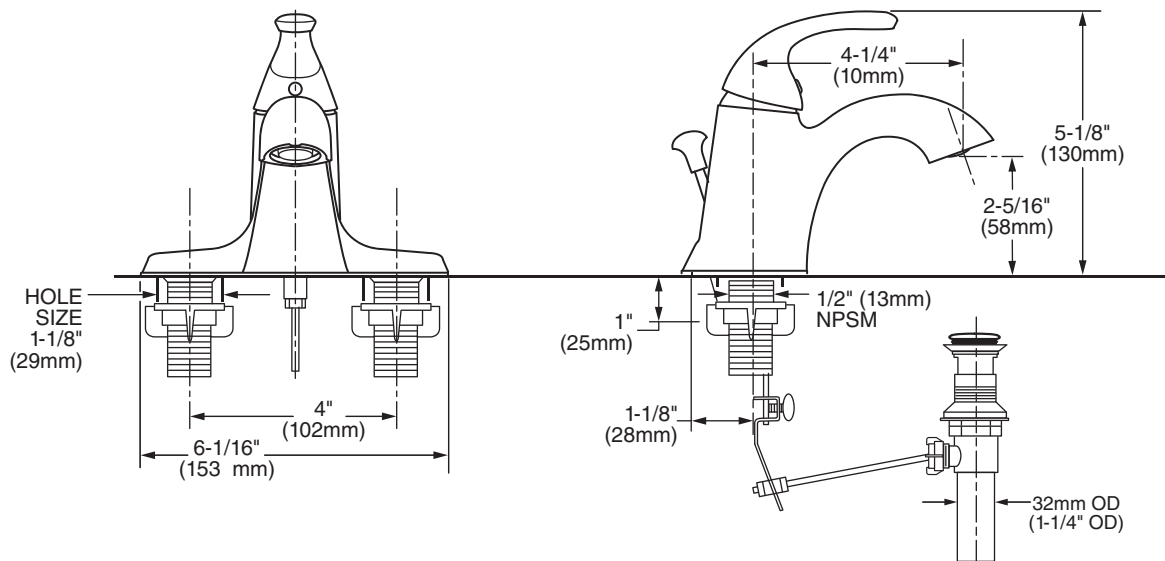

GENERAL DESCRIPTION:

Centerset lavatory faucet on 4" centers. Washerless ceramic disc valve cartridge. Flex inlet supplies with 3/8" compression thread. Durable waterway with male inlet shanks. Metal body. Metal lever handle. Pop-up drain body with 1-1/4 inch (32mm) tail piece. 1.5 gpm/5.7L/min. maximum flow rate.

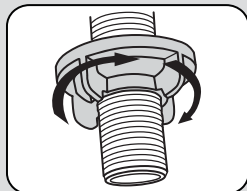

Quick Spin™ Nuts:

- Hand tighten
- No tools required

PRODUCT FEATURES:

Simple Installation: Fast and easy one person installation. Faucet drops in from top. Quick Spin™ Nuts hand tighten.

Ceramic Disc Valve Cartridge: Assures a lifetime of drip-free performance.

Lead Free: Faucet contains $\leq 0.25\%$ total lead content by weighted average.

Longer Spout: Provides extended reach into lavatory.

SUGGESTED SPECIFICATION:

Single control lavatory fitting shall feature a durable waterway with flexible inlet hoses and 1/2" male inlet shanks. Shall also feature washerless ceramic disc valve cartridge. Shall also feature a pop-up drain. Fitting shall be American Standard Model #9090.110.002, SKU #40065.

CODES AND STANDARDS

These products meet or exceed the following codes and standards:

ANSI A117.1
ASME A112.18.1
NSF 61/Section 9
CSA B 125

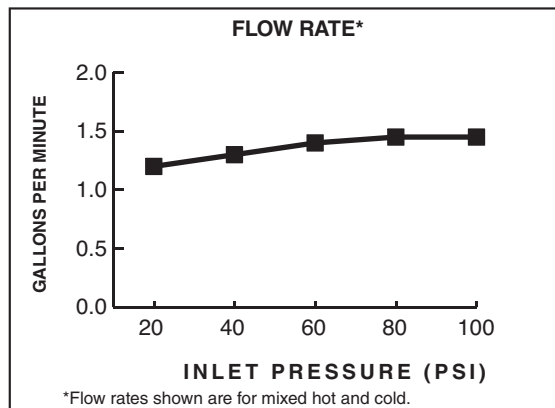

Product Number	Description
9090.110.002	Centerset lavatory. Metal lever handle. Pop-up drain. Quick Spin™ Nuts. Polished Chrome finish. SKU #40065.



Meets the American Disabilities Act Guidelines and **ANSI A117.1** Requirements for the physically challenged.